

A woman with long, vibrant red hair is captured in a dynamic, mid-air pose. She is wearing a black, sleeveless, flowing dress. Her hair is fanned out in a wide arc, suggesting rapid movement. Her right arm is extended upwards, and her left arm is bent with the hand pointing downwards. The background is a plain, light gray.

ABERDEEN
PERFORMING
ARTS

Conference & Events
Venue Collection

Extraordinary

Contents

Our Story.....	3
Our Offer	4
Our Iconic Venues	
Music Hall.....	5
His Majesty's Theatre	12
Lemon Tree	19
Our Welcome.....	24
Accessibility	26
Landmark Locations	27
Future Proof Technology	28
Food for Thought.....	30
Layout Examples.....	31



About us

We run three iconic, city centre venues at the heart of the arts and cultural scene in the North-east. Our mission is to create a spark and we take our inspiration from the sparkle in the granite here in Aberdeen, the Granite City.

Making a difference

By choosing to work with us, you are leaving a lasting legacy by supporting a not for profit charity making a difference through the arts. You are investing in projects with young artists and musicians, our youth theatre, choirs, activities in schools and communities, our early years programme and our three festivals.



Why choose us?

- Stage your event in a setting like no other. Our venues will take your breath away.
- Our dedicated Conference and Events Team will be with you every step of the way.
- Our friendly, award-winning team will exceed your every expectation.
- Our talented in-house chefs will tempt your taste buds.
- Our technical team stages 1000 performances a year. We know how to put on a show!
- Our city centre location with good road, rail and airport links, close by parking and accommodation means we're only a heartbeat away.
- Our year round cultural programme is the perfect choice for your down time.

Our iconic venues

MUSIC
ABERDEEN
PERFORMING
ARTS **HALL**

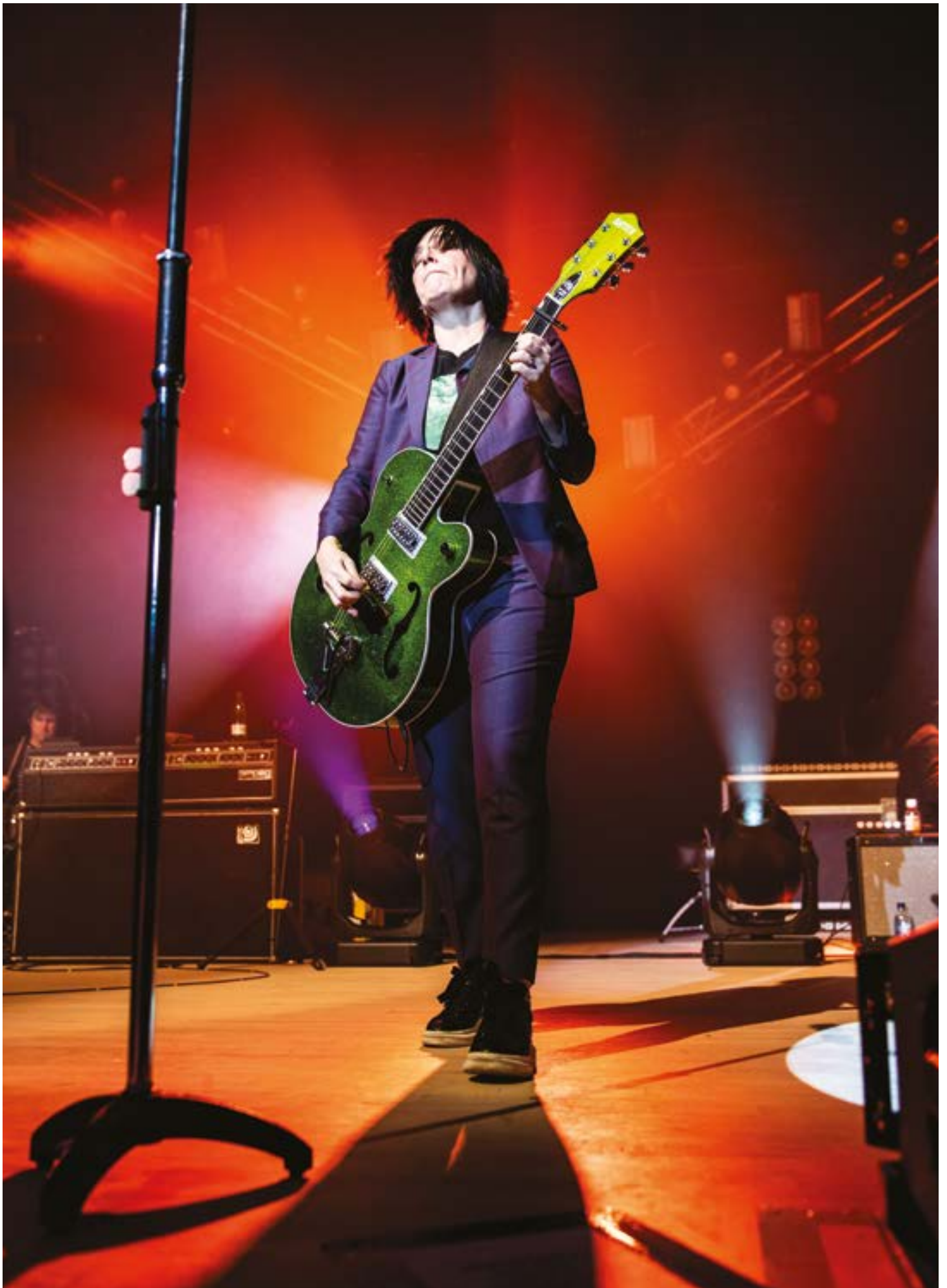

Q: What do Charles Dickens, David Bowie, Alex Ferguson, Sharleen Spiteri and Mikhael Gorbachev have in common?

A: Aberdeen Music Hall!

Be prepared to be amazed and inspired when you step into the Music Hall. We invite you to join us to create unique events, enjoy life affirming performances and make magical memories.

Our treasured Music Hall can hold a variety of events from small meetings, to large conferences, award dinners and exhibitions in the timeless elegance of this Archibald Simpson designed building.

In addition to our stunning concert hall, we also have characterful and versatile spaces to offer you that would work beautifully as breakout and exhibition spaces, for pre-concert receptions and hospitality or for stand alone meetings and events.

Music Hall Areas:

Auditorium:	370 Sq.m
Rondo:	102 Sq.m
Big Sky Studio:	103 Sq.m
Coda Café Bar:	158 Sq.m
Tutti Studio:	104 Sq.m
Piccolo:	23 Sq.m



Music Hall

handsome, pre

Auditorium

The historic auditorium at the Music Hall was built in 1859 and is a perfect example of a classic Victorian 'shoe-box' concert hall.

It has a magnificent natural acoustic, is adorned with several beautiful murals by Aberdonian artist Robert Douglas Strachan, and features a very fine pipe organ built by 'Father' Henry Willis.

Big Sky Studio

Big Sky Studio is at the heart of the Music Hall adjacent to the main auditorium. It is accessible from the promenade, with doors directly into the main auditorium, and direct access backstage. The layout can be configured flexibly to suit requirements with dedicated loose, stackable seating and a maximum capacity of 90 (theatre style). Staging can be set in place with or without a lectern with projection facilities available. It has a solid oak floor and is an ideal breakout room from the main auditorium, used together with Rondo or as a stand-alone booking for a reception, talk or meeting.

Rondo

Rondo is a stunning circular space accessible from the foyer and the promenade with a solid oak floor and connected doors to Big Sky Studio. Ideal for elegant dining or used together with Big Sky Studio, it is a truly flexible space, easily configured for a variety of events.

Coda

Coda is our fabulous café bar located opposite Big Sky Studio, accessible from the promenade. It is open all day from 9.30am for snacks, light lunches, tea, coffee and cake, soft or alcoholic drinks. It is available as a fully staffed bar to sit alongside your event or the ideal place for your delegates to take a break.

Tutti Studio

Tutti Studio is located on the first floor at the front of the building and is accessed via stairs or passenger lift beside reception. It has a solid oak floor and is perfect as an additional breakout space or for workshops, talks and rehearsals.

Tutti has dedicated loose, stackable, brightly coloured, seating with a maximum capacity of 90, which can be configured to suit each event. There is a direct input socket to allow for connection to the projector and to play recorded sound. The room also houses a Yamaha U3 upright piano. There are toilets adjacent, including an accessible toilet.

Piccolo

Piccolo is our meeting room located on the first floor at the front of the building and is accessed via stairs or passenger lift beside reception. It has permanent meeting room tables and chairs which can accommodate up to 12 people comfortably and a projector. It is carpeted and there are toilets adjacent.

Stage

The stage is a permanent construction with a solid oak wooden flooring. There is no proscenium arch, and the stage has a rake of 1 in 40. A 'black-box' setup can be constructed using drapes.

Dimensions:	
Width (front of stage)	13.45m
Width (mid-stage)	16.9m
Width (rear wall)	14.9m
Depth	10.2m
Height (from hall floor)	1.44m
Height (from stage to ceiling)	13.5m

Hall

The hall is flexible with three standard layouts for events. The stalls can be configured theatre-style, banquet-style tables and chairs, or cleared for standing or exhibition setup. The seating in the balcony and the raked section at the rear of the stalls is fixed.

Capacity:	Stalls	Balcony	Total capacity
Theatre-style seating	823	482	1,305
Standing/seated	1,018 (standing)	482 (seated)	1,500
Banquet-style seating	532 (300 tabled)	482	1,014

Dimensions:	
Width	20.5m
Depth (front of stage to rear wall)	25.1m
Depth (front of stage to start of raked seating)	20m
Height (floor to ceiling)	14.9m
Height (floor to overhang of balcony)	2.75m

Big Sky Studio

Dimensions:	
Width (to auditorium wall)	10m
Depth (to promenade wall)	10m
Height (to lighting bars)	4.3m
Height (to ceiling)	5.9m

Tutti Studio

Dimensions:	
Width (to Piccolo wall)	17.4m
Depth (to exterior wall)	5.9m
Height (to lighting track)	3.05m
Height (to ceiling)	3.8m

Piccolo

Dimensions:	
Width (to Tutti wall)	4.0m
Depth (to exterior wall)	5.93m
Height (to lighting track)	3.0m
Height (to ceiling)	3.85m

Rondo

Dimensions:	
Width (to Big Sky wall)	9.5m
Depth (to promenade wall)	9.5m
Height (to ceiling)	5.9m

Coda

Dimensions:	
Width (to exterior wall)	9m
Depth (from bar to glass wall)	14m
Height	2.89m

Ground floor

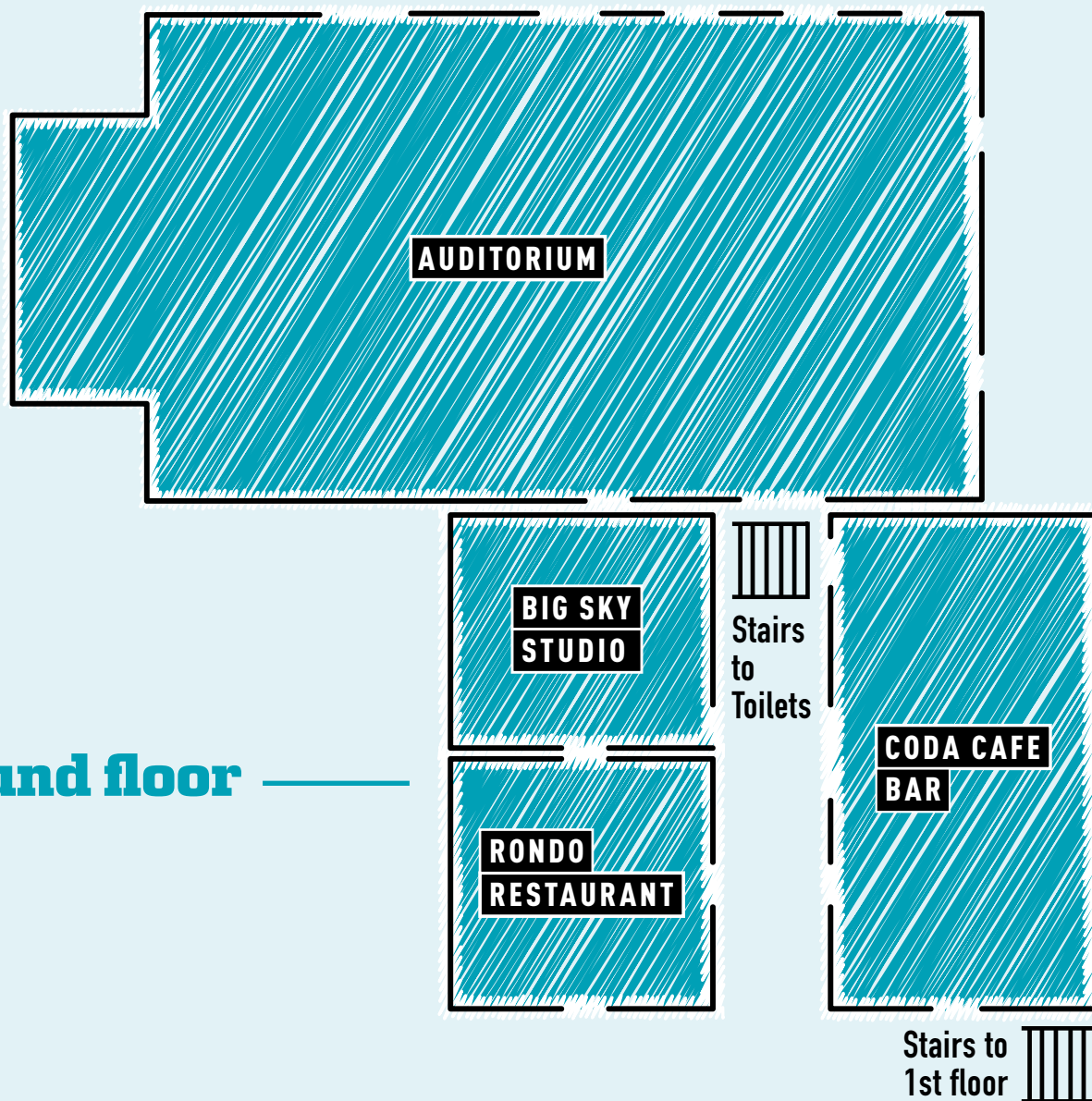

Main
Entrance

First floor

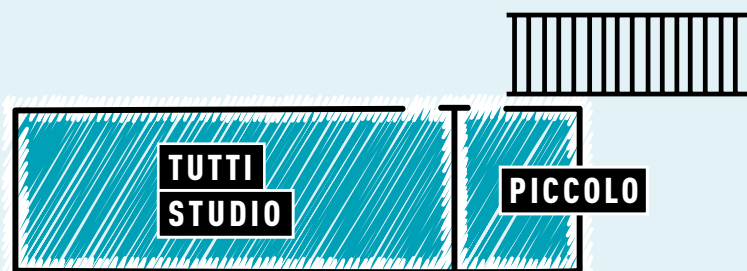

events@aberdeenperformingarts.com

Our iconic venues

HIS MAJESTY'S
ABERDEEN
PERFORMING
ARTS
THEATRE



Q: What do His Majesty's Theatre, the London Coliseum, the London Palladium and the Belfast Grand Opera House have in common?

A: They are all category A listed national treasures designed by Frank Matcham, the foremost theatre designer of the Victorian era.

An Edwardian masterpiece, this beautiful Category A listed theatre has been a landmark location in the city since it opened in 1906, attracting world-class shows and performers ever since. A contemporary extension in 2005 created an exciting blend of modern and historic architecture and gives us additional spaces for hospitality, dining, meetings, workshops, and rehearsals.

HMT's stunning auditorium was described by Billy Connolly as a gigantic wedding cake! Our contemporary 1906 Restaurant and Terraces bar with our bee garden are also available for hire.

Our talented chefs can create a menu to tantalise your taste buds too! Hold your event in spaces with charm and character looked after by our wonderful, creative teams.

HMT Areas:

Terraces Bar:	38 Sq.m
1906 Restaurant	100 Sq.m
Café 1906	86 Sq.m
Education Studio:	103 Sq.m
Main Auditorium:	1,490 fixed seating

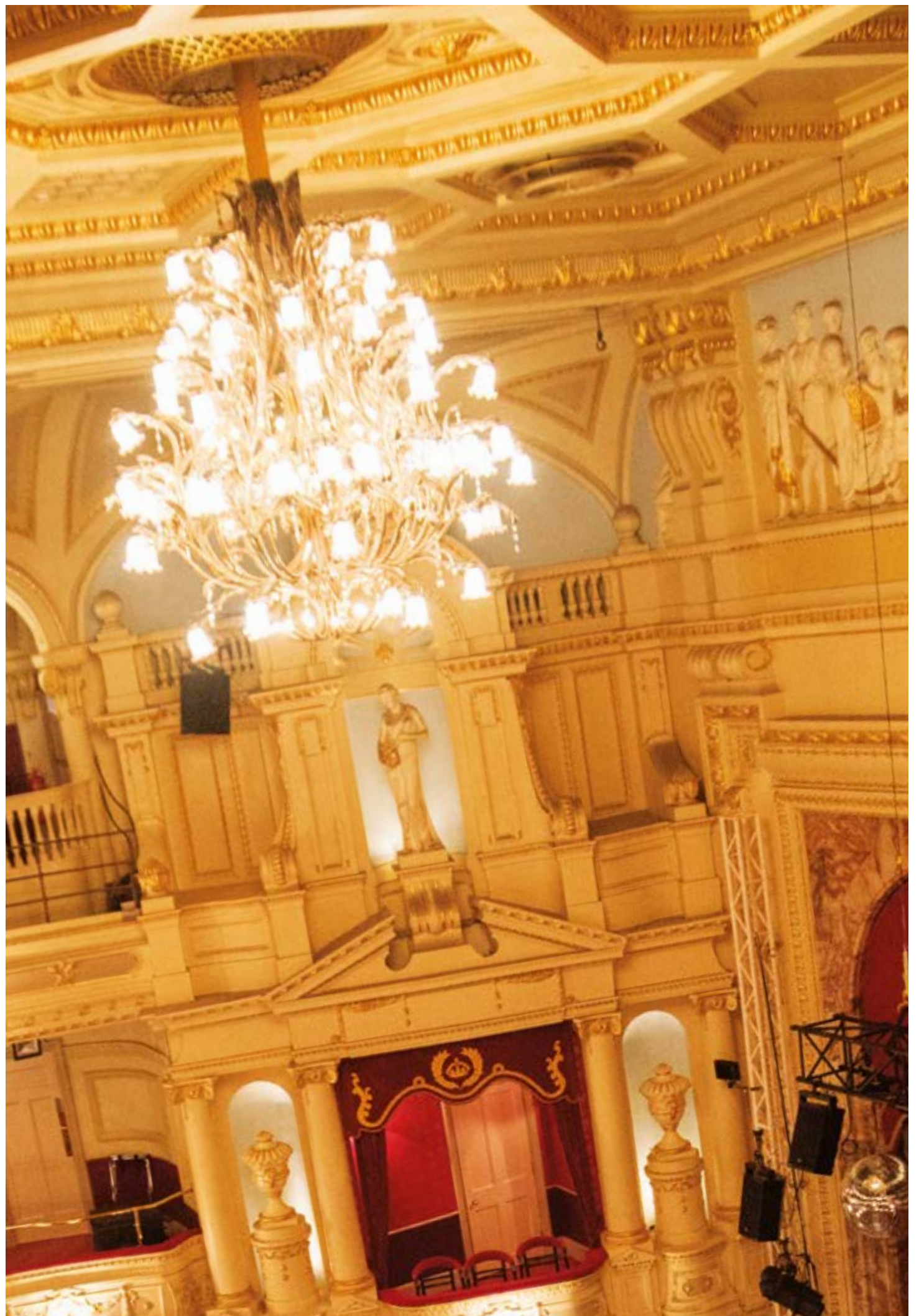

Auditorium

The beautiful auditorium at His Majesty's Theatre is a fantastic example of the work of renowned theatre designer Frank Matcham. The seating is configured over four levels (stalls, dress circle, upper circle, balcony) and there are four boxes adjacent to the stage.

The stage is a permanent construction with solid wooden flooring covered with black linoleum. There is a marble proscenium arch, and the stage has a rake of approximately 1 in 28.

Education Studio

Our Studio is perfect as a break out, rehearsal, reception space alongside the auditorium or as a stand alone meeting or event space. It has a solid wooden sprung floor, projection facilities and an upright piano if required. It can be accessed via the main entrance to the theatre or from Stage Door.

1906 Restaurant

His Majesty's Theatre has bars, cafés and restaurants which can be for hire subject to availability.

1906 Restaurant has wonderful views over Union Terrace Gardens and Aberdeen Art Gallery. It is 100sqm and can accommodate up to 80 for dining.

Dress Circle and Stalls Bars

We have two bars located on the ground floor and lower ground floor, adjacent to the dress circle and stalls respectively.

The Terraces

The Terraces is adjacent to 1906 Restaurant and can be booked for private dining or receptions. It is 38sqm, has bar facilities and an accessible toilet.

Auditorium

The auditorium has a fixed seated layout across four levels. All areas, with the exception of the balcony, are fully accessible and contain fixed wheelchair locations (11 in total).

Capacities:	
Stalls	664
Dress Circle	181
Upper Circle	226
Balcony	400
Boxes (2x Lower, 2x Upper)	18 (2x5, 2x4)
Total	1,491

Note – actual, sellable capacity may vary depending on specific requirement e.g. orchestra pit, disabled spaces, etc.

Stage

Dimensions:	
Width (proscenium)	9.16m
Width (max stage)	20.15m
Width (between fly floors)	15m / 12.25m
Depth (max stage to paint frame)	12.2m
Depth (iron to last flying bar)	10.74m
Depth (iron to stage front)	0.9m
Depth (last flying bar to back wall)	5.79m
Height (proscenium to pelmet)	7.086m

Stage clearances:	
Stage floor DS to Grid US	15.4m
Stage floor US to Grid US	15.04m
Stage floor DS to Fly Floor US/PS	6.95m
Stage floor US to Fly Floor US/PS	6.56m
Stage floor DS to Fly Floor US/OP	7.40m
Stage floor US to Fly Floor US/OP	7.01m

Studio

Dimensions:	
Width	11.1m
Depth	9.3m

Backstage

His Majesty's Theatre has seventeen dressing rooms. Rooms can be reserved alongside the main auditorium if required. They are securely accessed via Stage Door.

There is direct access front of house via a pass door located just below stage level.

To Auditorium & Bars

Main Entrance

BOX OFFICE

CAFE 1906

Ground floor

THE
TERRACES

First floor

1906
RESTAURANT

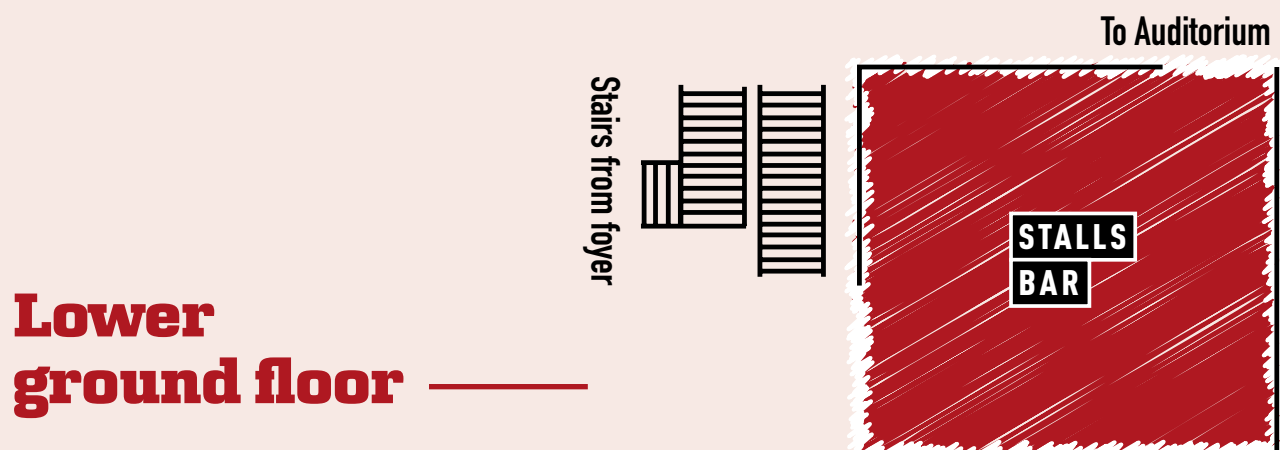
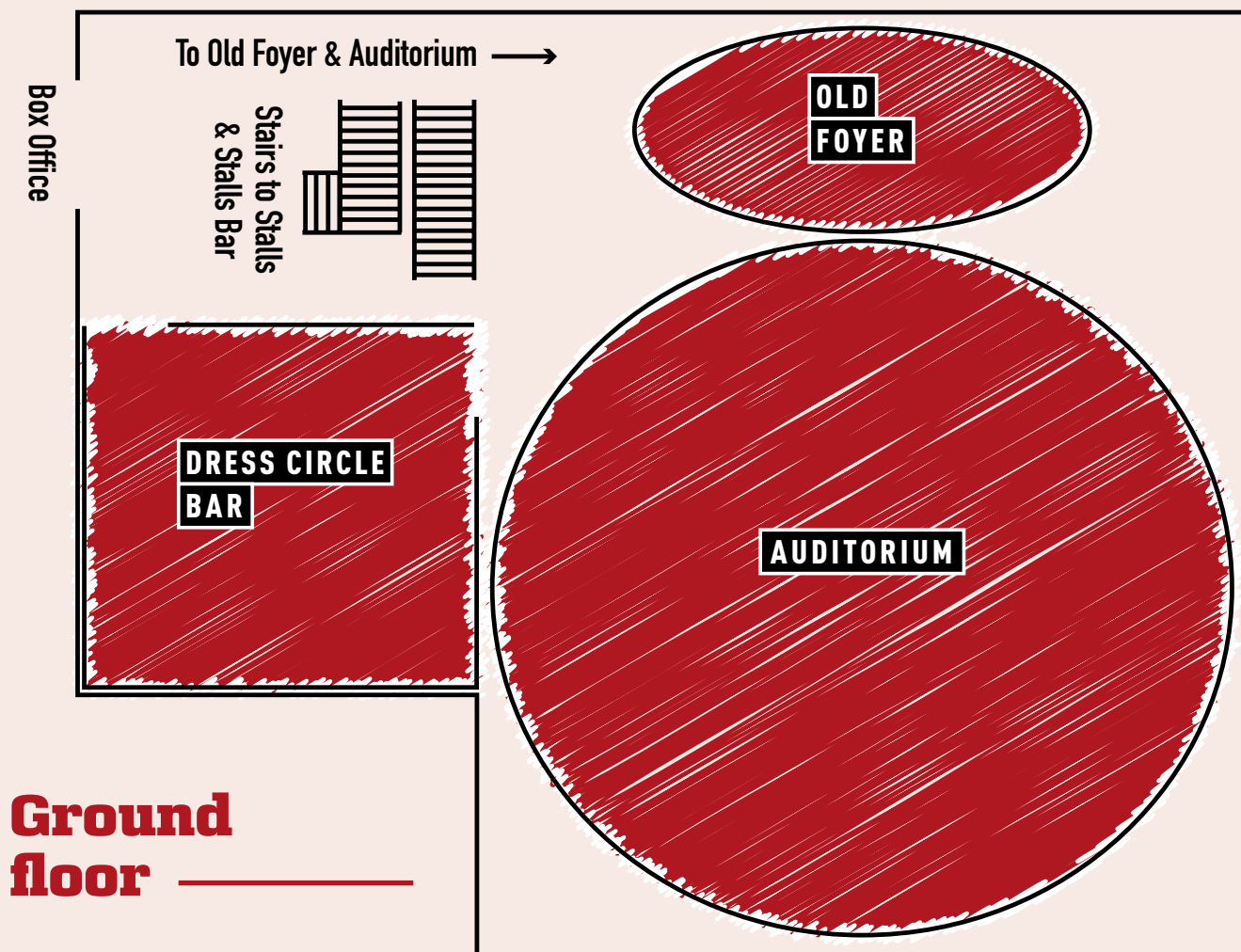

Our iconic venues

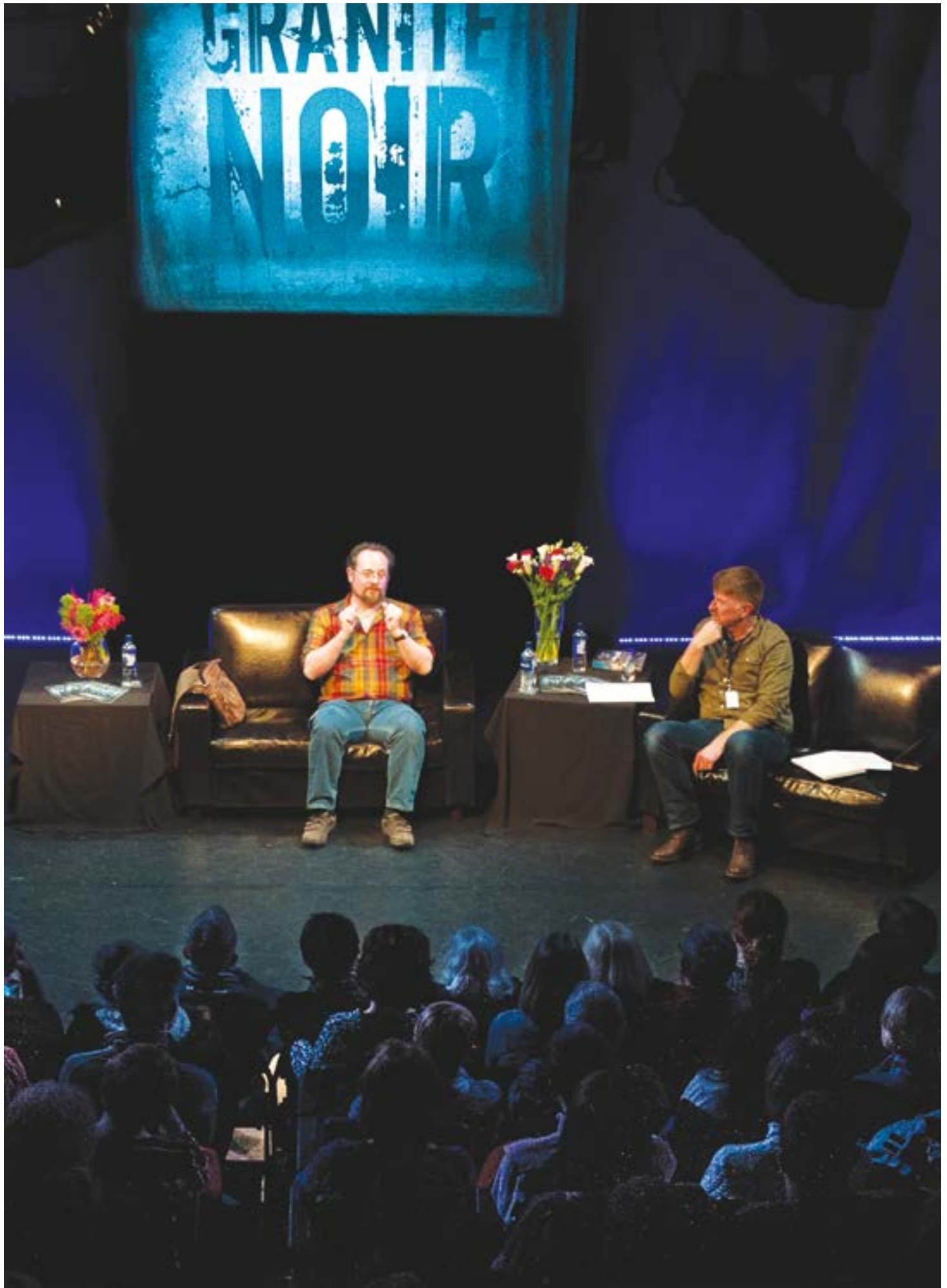

Q: What do The Libertines, Jamie Cullum, Sarah Millican and Radiohead have in common?

A: They all took to the stage at the Lemon Tree for the first time before going on to fill arenas, win awards and grace our TV screens.

The Lemon Tree's reputation as a great music venue is legendary. It is loved by our clients as a space for everything from drinks festivals and exhibitions to team meetings, talks, workshops and networking events - and we are always up for anything a bit creative.

It is a fantastic, versatile, multipurpose space that our wonderful team can transform in the blink of an eye with a bit of imagination and technical wizardry.

We have two main spaces which you can really make your own – the Lemon Tree Lounge which seats 290 and the Lemon Tree Studio with a seating capacity of 166 – both with stage, screen, projection, and PA facilities.

Lemon Tree Areas:

Lounge: split across 3 levels 288 Sq.m

Studio (stage): 77 Sq.m

Kate's Bar: 27 Sq.mw

Lounge

The Lounge is an intimate space with amazing sound, at the heart of Aberdeen's gig culture. The space, which has a bar within it, is predominantly a music and comedy space, but is also used for some theatre including the popular A Play, A Pie and A Pint series. The audience area is over three levels gradually raising from the front.

It is ideal for mini festivals, exhibitions, talks and networking events.

The Lounge is a flexible space and there are three standard layouts for events in the space. Seating is provided with individual loose folding chairs, and we have sufficient tables for a full cabaret layout.

Stage

The stage is a permanent construction set in the front corner of the room. Access to the stage is via a draped off entrance just inside the door to the room.

There are two steps up onto the stage.

Studio

The Studio is located on the first floor with access from reception via the main stairs and direct access backstage. The Studio contains a seating bank with a capacity of 166. The seating bank can be retracted to provide a standing or exhibition layout. It has a varnished beech floor.

As standard, the stage is set with black dance floor and three side masking legs in place down each side. There is a permanent cyclorama in place which can be covered by a full set of upstage black tabs.

The Studio has two dedicated dressing rooms located at the rear of the space and accessible from either side via stairs. Each dressing room has one shower and one toilet, as well as dressing table units and illuminated mirrors. The area immediately outside the dressing rooms has tea and coffee making facilities.

Kate's Bar

Named with a small nod to the original name of the building, St Katherine's Club. It is a small bar located near the Studio, beautifully decorated and full of charm, this is an ideal space as a breakout area or for a small meeting or intimate networking opportunity.

Backstage

The Lounge has one dedicated dressing room, which is the Chapel, located on the first floor. The room is lockable and contains a fridge, kettle, tea/coffee making facilities, iron/ironing board, full length mirror, table and chairs, plus an upright piano.

Subject to availability, it may be possible to provide additional rooms including:

- Kate's Bar and our rehearsal room.

Lounge Stage

Dimensions:	
Width (at its widest)	6.2m
Depth	5.3m
Height (from hall floor)	0.61m
Height (from stage to ceiling)	2.3m

Lounge Layouts

Capacities:	
Standing	550
Theatre-style seating	290
Cabaret seating	150

Studio

Dimensions:	
Width	11m
Depth (to cyclorama)	7m
Height (to lighting bars)	4.5m

Kate's Bar

Dimensions:	
Width (to exterior wall)	3.4m
Depth (to exterior wall)	7.7m
Height (to ceiling)	2.7m

Ground floor

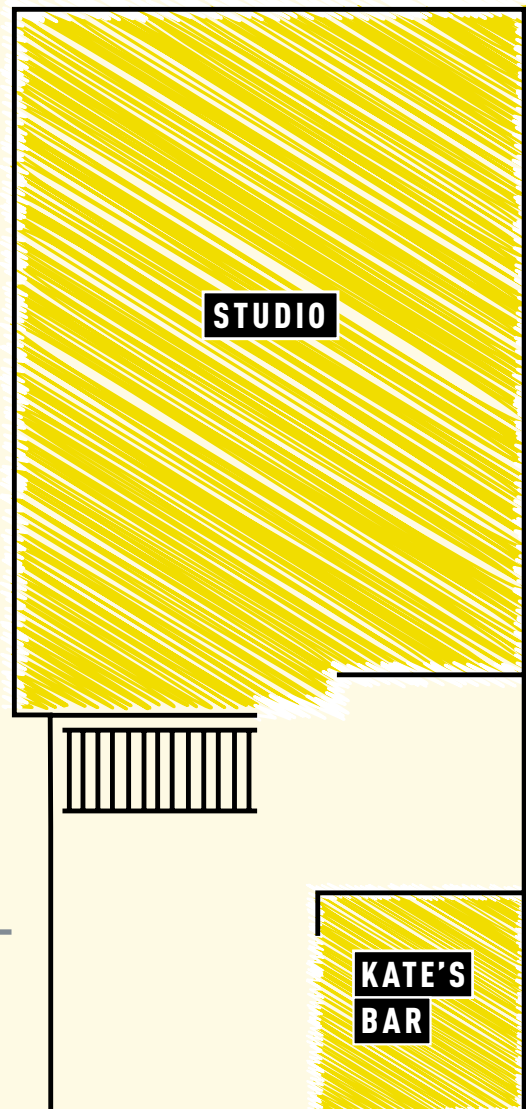
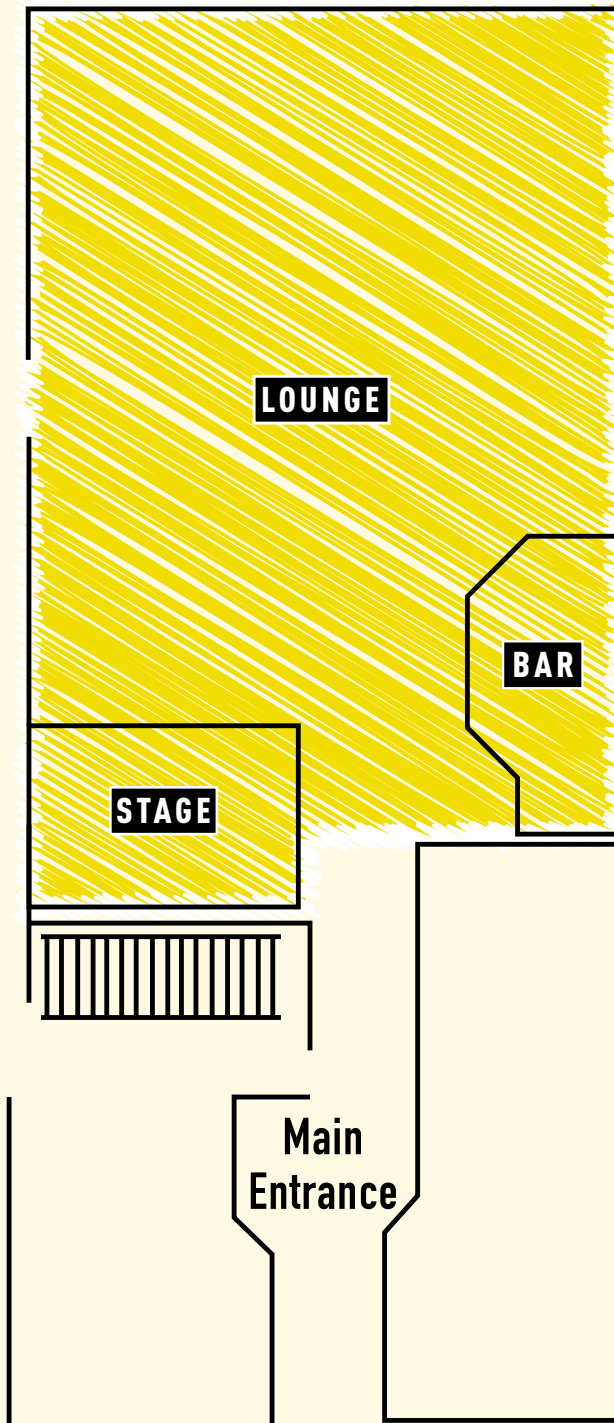

First floor

Our welcome



OUR FRONT OF HOUSE TEAM will ensure you receive a warm welcome and will always go the extra mile to make your visit extraordinary. If you have any additional support needs just let us know and we're on it! Wheelchair users have full street to seat access to all of our venues.

OUR IN-HOUSE TECHNICAL TEAM looks after everything on the stage. Between them, they have decades of experience in lighting, sound, audiovisual and stage management.

OUR OPERATIONS TEAM takes an enormous pride in lovingly maintaining our buildings. They are on hand to make sure your set up goes smoothly and make any last minute changes.

OUR HEAD CHEF AND HIS TEAM offer tastings, love to talk about food and are always creative with your menu and your budget.

OUR CREATIVE TEAM can make your conference or event special by running delegate warm up workshops for you and suggesting talented young musicians for your receptions.

We hold the government's externally validated customer service excellence accreditation with special commendations in leadership, access and customer focus.



“Aberdeen
Performing Arts
remains a truly
outstanding organisation
and should be upheld as an
example of excellence for
customer service delivery
in the North-east
of Scotland.”
Customer Service
Excellence Assessor



We are passionate, talented, experienced and we all live our company values - optimism, curiosity, loyalty, team work and resilience.

Accessibility



We are passionate about having our venues fully accessible. All our venues include, level access from street, lift access to all levels both backstage and front of house, wheelchair spaces in all of our auditoriums and our state of the art sesame lift allowing access for all through the main door of the Music Hall for the first time in the building's 200 year history.

All venues are equipped with hearing assistance provided by Sennheiser Mobile Connect which is accessed by users via mobile device.

Captioning and Audio Description and BSL facilities can all be provided with our in-house equipment and trained service providers.

Landmark locations



Our three city centre venues are widely renowned as iconic cultural landmarks not just in Aberdeen, but across the country.

We are well connected. No matter your mode of transport, we are within easy reach when you get here.

All three venues are within 10 minutes' walk of the train and bus station, and just a 20 minute journey from Aberdeen Airport. We are well situated to welcome you.

We can suggest accommodation to suit all budgets within minutes of our venues.



Future proof technology



Music Hall Stepping In digital artspace

We invest in the latest business systems and technology to support our work on and off stage and we make sure systems are safe, secure and compliant.

We like to play with technology and innovate – check out our 4m x 3m digital screen in our Music Hall Stepping In digital artspace.

We have dedicated wi-fi across all three venues. All of our venues also have a state of the art wifi based, assisted hearing system that enables multi-channel audio to be streamed in real time to your smartphone or tablet.

Our sound, lighting and audiovisual equipment and technology is professional performance standard.

Our expert team is always on hand to advise, assist or co-ordinate your technical requirements.

We know how to put on a show



Our Technical team stages 1000 performances a year.

The equipment specified can be made available as standard at no additional charge with advance notice. Standard hire also includes a dedicated, experienced technician.

Lighting, sound and audiovisual are all available from our technical team, using our in-house equipment.

We have both radio mics and hand held mics available to cover a range of requirements.

Radio microphones x8 Sennheiser ew500 G3 radio receiver
 x4 Sennheiser e965 handheld microphones
 x4 SK500 G3 belt packs
 (additional mics can be hired if required and recharged)

We have a large projector and screen suitable for use in all spaces

AV (Music Hall) Optoma EH461 5000 Lumens projector
 Sony VPL-FX35 5000 Lumens projector
 Fastfold screen (front and rear screen)
 16:9 4.42mx 2.29m 200 inch diagonal

AV (Lemon Tree) Epson EB-535W Ultra Short Throw Projector w/ Unicol hanging bracket for the Studio.

We can set the stage for you using rostra and drapes and have the following essentials available.

Podium x1 conductor podium

Lectern x1 presentation lectern

Pianos (Music Hall) Steinway Model D Concert Grand – available only with permission
 Yamaha C3 Grand
 x2 Yamaha U3 Upright
 (Tuning charge for use of pianos will be recharged)

Full technical specifications for each venue can be provided on request and our team will be happy to work with you to discuss and provide any additional extras.

Food for thought



Our experienced food and beverage team run our busy, award-winning bars, café bars and restaurants all year round and enjoy a challenge. Our staff are hand picked and our kitchens are fully equipped.

As a creative organisation we believe in celebrating individuality and our approach to food and beverage is no different. Our talented in-house chefs are on hand, our food is prepared on site, tailored to your requirements, sourced from artisan, independent and local suppliers. Afternoon tea, sharing platters, fine dining, five course dinners, canapés, cocktails, wine tastings and food and drink pairings – we can make it happen for you.

Our iconic spaces are truly flexible...



Auditorium: stage with projector



Big Sky Studio: reception style



Auditorium: fixed seating



1906: tabled



Studio: stands



Kate's Bar: reception style